

# TOSHIBA

## EVERYTHING YOU WANT IN ONE DEVICE

**e-STUDIO2523A**



**TOGETHER  
INFORMATION**

# EVERYTHING YOU WANT IN ONE DEVICE

This series exhibits fast copy speed as well as a host of features that provide high productivity to meet the requirements of our customers. The devices come with power saving features that will greatly reduce energy consumption which in turn lowers the total cost of ownership.

Reliability is further enhanced with higher durability parts, thereby increasing device uptime and lower cost of maintenance.



## CONVENIENT OFFICE APPLICATIONS

### > ID Copy

Copy both sides of the card onto single side paper with just 1 simple step.

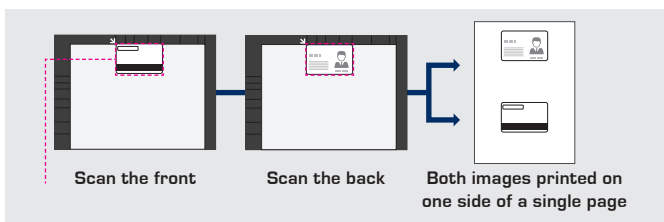

### > Department Code and Device Management

Easy management of user/department usage. Administrator can receive notification on alerts or errors.



### > 2-1/4-1

Combine 2 or 4 documents onto a single sheet to reduce paper consumption.

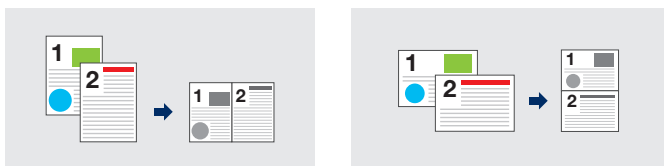

2IN1: Copies two pages on a sheet of paper in portrait or landscape orientation.



4IN1: Copies four pages on a sheet of paper in portrait or landscape orientation.

### > OPTIONS

#### e-STUDIO2523A



PFU  
MY-1043-B



Desk  
MH-2506



Co-packed Toner      2,000 (Yield)  
Black Toner      6,000 (Yield) / 17,500 (Yield)



Beware of Imitation or

Remanufactured Parts and Supplies.

Only Toshiba genuine parts & supplies are compliant to the RoHS directive & MSDS certified. Even though they may say "for use in Toshiba," or "equivalent reliability and performance", third party supplies can't match Toshiba's exacting quality standards. They don't undergo Toshiba's stringent qualification and rigorous testing to ensure that all components work together in perfect harmony. Plus, they void your warranty. Be Smart. Be Safe. Always purchase from an Authorised Toshiba Distributor so you can be sure you're not inadvertently installing imitation/remanufactured supplies, which can shorten product life, hamper productivity, and irrevocably damage your Toshiba equipment.

SPECIFICATIONS		e-STUDIO2523A	
GENERAL			
Print & Copy Speed	25 cpm		
Copy & Print Process	Indirect electrostatic photographic method		
Warm-up Time	15 sec		
Paper Size & Weight	Drawer: A3 / A5-R (64 - 80 g/m2) Bypass: A3 / A5-R (52 - 216 g/m2)		
Paper Capacity (Standard)	Drawer x 1 : Max paper 250 sheets. Stack Feed Bypass Max 100 sheets		
Max. Paper Capacity	600 sheets		
Processor	ARM9 360MHz		
Memory	256MB		
Dimension	W575 x D540 x H402 (mm)		
Power Consumption	Max 1.5kW (220 - 240V)		
COPY			
Max Original Size	A3		
First Copy Out time	Less than 6.4 seconds		
Multiple Copy	1 - 999 copies/Ten key input		
Zoom	25% to 400% (1% increment)		
Copy Mode	Text, Text/Photo(Default), Photo		
PRINT			
Printing Resolution	2400 dpi x 600 dpi (with smoothing)		
Page Description Language	GDI		
Operating Systems	Windows 10, Windows 8.1 (32/64 bit), Windows 7 (32/64 bit) (SP1 Recommended) Windows Server 2016, Windows Server 2012/R2 (64 bit) Windows Server 2008 SP2 (32/64 bit), Windows Server 2008 R2 SP1 (64 bit)		
Interface	USB2.0		
SCAN			
Scan Resolution	600 dpi x 600 dpi		
Scan Speed	Up to 25 spm		
Supported Destination	Scan to USB/TWAIN		
Option Item List:			
Reversing Automatic Document Feeder (RADF)	MR-3032		
Paper Feed Unit (PFU)	MY-1043-B		
High Desk	MH-2506		

For more information and a complete list of MFPs and Solutions, please contact us:

**Toshiba TEC Singapore Pte Ltd**  
2 Ang Mo Kio Street 62  
Singapore 569138  
Tel : (65) 6481 9488  
Fax : (65) 6481 2385

Technical data is subject to change without prior notice. All company and/or product names are trademarks and/or registered trademarks of their respective manufacturers in their markets and/or countries. All rights reserved. We are constantly making efforts to deliver the latest status of data to our partners. Specifications for some models may change in the time between the production and the release of this documentation. Productivity and paper specifications are related to paper size of A4 and a paper weight of 80 g/m<sup>2</sup> if not otherwise mentioned.

Copyright ©2019 TOSHIBA TEC.



#### International Office Machines Ltd.

Corporate Office  
Ranks Business Centre (3rd Floor), KA 218/1 Pragati  
Sarani, Kuril, Dhaka 1229.  
**Hotline: 09611858585**, Tel: 8418523 | Fax: 8417589  
E-mail: info@iomltd.com  
Branches  
**Chattogram:** 613705, 01714084429 | **Bogura:** 65531,  
01711890615 **Khulna:** 732372, 01716749065 | **Sylhet:**  
712240, 01711160285

Distributed by



TSE Version 01